

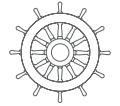

# Oceanic De-Ice | Single and Double Deck Navigation Lights for Polar Areas

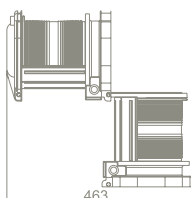

Starboard	Port	Masthead	Stern	Towing	Signalling	Manoeuvring	Suez	Steering
112,5°	112,5°	225°	135°	135°	360°	360°	135°	30°
3nm	3nm	6nm	3nm	3nm	3nm	3nm	3nm	>2nm
Green	Red	White	White	Yellow	White Red Green Yellow Blue	White	Red	Blue

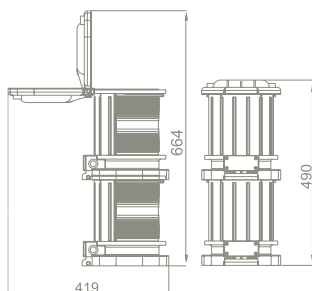
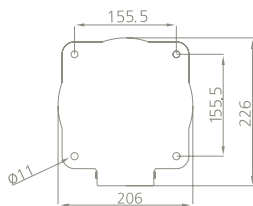
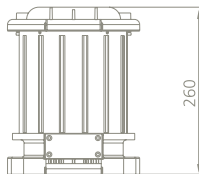
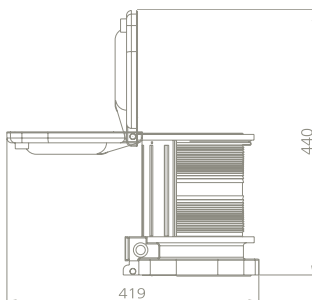

## Product Description

Though the filament bulbs used in our navigation lights make these not to be affected by low temperatures as they emit a considerable amount of infrared heat, in certain conditions of circumpolar navigation, it is needed to provide extra-heating for deicing the lens surfaces as it is recommended by the DNV in its document "Class notation de-ice". This is achieved in our Oceanic lights by means of a radiant wire situated in the lower part inside the lantern and isolated from the base by four technically superior ceramic columns, emitting up to 60 watts of heat and controlled by a bi-metal thermostat.

## Application

For all sea going vessels with a length of 20 meters or more and occasionally sailing in polar waters.

Light in compliance with the International Regulations for Preventing Collisions at Sea 1972 (COLREGS-IMO72).

## Approval

Det Norske Veritas (DNV), according to EN-ISO 14744.

## Technical Features

Housing:	Polycarbonate reinforced with fibreglass
Lens:	Polycarbonate fresnel lens, shock and UV resistant
De-icing capabilities:	Better than 30° centigrade below zero
Fully resistant to sea environment	
Non magnetic	
Integrated terminal box in every light	
Access to bulb from above:	Lamp easy to change
Lamp holder:	P28S
Weight:	2 kg
Protection:	IP 66
Input voltage:	24V 110V 220V
Power consumption:	40W 60W 65W

## Optionals

Delivery of custom made lights upon request  
Antivibration system